

# liveconfigurator™

REAL TIME DESIGN

## User Guide for: Frameless Glass Balustrade Systems



We have been developing Liveconfigurator™ for over two years and plan to continue to add more of our products and configurations in the years to come. We have attempted to keep Liveconfigurator™ simple to use whilst offering a wide choice of options. You can usually see a picture of your selection which will change as you work.

Our aim is to have a full range of alternative systems of Frameless Glass Balustrades, and have started with our Wedge-Loc™ Slim Channel which is now available for configuration.

## WEDGE-LOC™ SYSTEM

TESTED TO BS6180

### FEATURES:

- Satin anodised finish
- Stainless cladding not required
- Great value
- Quick to install
- Pre-drilled channel fixing holes
- Height to glass when packer fitted is 13mm
- Packer height 2mm



Base Fix Channel

**STEP A** Click

**GET STARTED**

This will take you to the Products which are available for you to configure.

**STEP B** Click on your choice.



Frameless Glass Balustrade Systems

For example:

**STEP C** Scroll down the page until you see the Template options and click on your preferred layout. This will take you to your preferred layout\* and you are ready to start your configuration.

PLEASE SELECT A TEMPLATE BELOW



\*Please note that not all layouts may be available for all systems, however they will be added as soon as possible.

**Q 1-4** Liveconfigurator™ will run through a list of simple questions. As you make your choices you will notice that the image alongside will change to show the parts you have selected. You may notice that some questions do not allow you a choice. This is because your selection will not configure in this way. And it will show a message saying:

**Option not available click NEXT to continue**

You may also find useful **information**, such as:



Or **warnings**



like this.

LENGTH: Always enter your lengths **in millimetres**. This is the important part as the total length you enter is the size you will get.

IMPORTANT: For example, if you are fitting up to a wall then the OVERALL length will be the wall to wall measurements on a straight length. If your system has corners then it will be the measurement to the centre of the corner which is important.

Please make sure you are happy with your selections before continuing by clicking on the NEXT button.



**Q 5** Choose you glass from the options provided.

On this page you will also find a guide price based on the selections you have made. This will not include such optional extras as bolts, or cleaning materials at this stage.

If you wish to go back at any time you can click on the PREVIOUS button to go back a page.



Next we provide a list of accessories that you may wish to purchase. You can also find useful information such as how many bolts you will need to install your chosen length.

**ACCESSORIES:** We now offer you a choice of useful accessories. They include the screws and fixing bolts which you may need with most systems. However if you do not wish to run through all the accessories, you can click on [SKIP ACCESSORIES](#) to fill in your details and collect your quote.

If you have already REGISTERED please tick the box so you don't need to fill in the whole form. You will then be asked to tick the box to confirm that the measurements you provided are correct.

**Finally:** Within a few minutes you will be sent an email with your quote, a basic drawing and a layout attached. To place an order please contact your local sales team who will be happy to advise. When you place your order we will also email you a full set of working technical drawings, including the glass panel sizes if you have ordered them.



# Installation Guide for: **WEDGE-LOC™ SYSTEM**

## BASE FIX INSTALLATION:

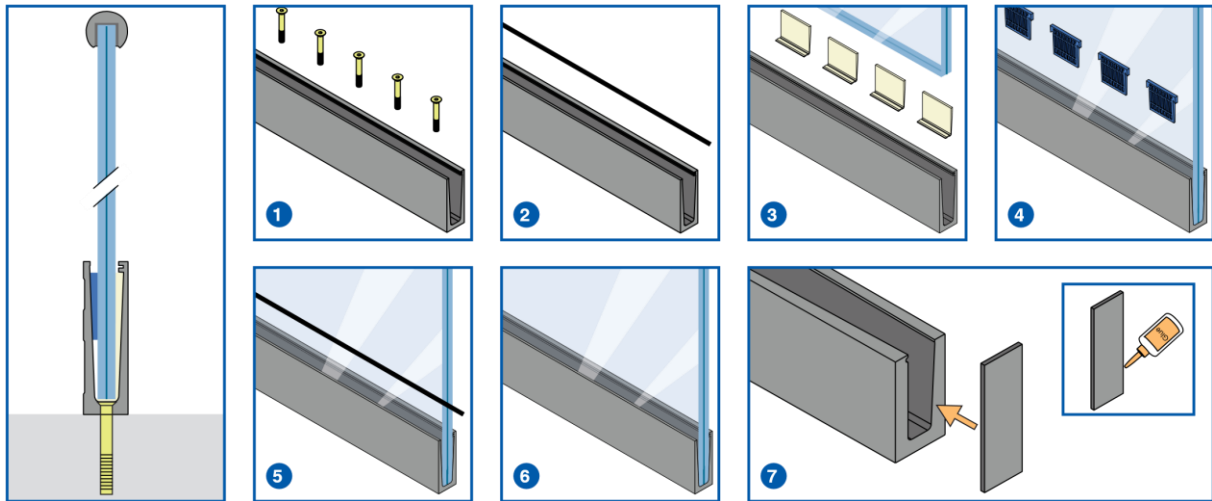

## SIDE FIX INSTALLATION:

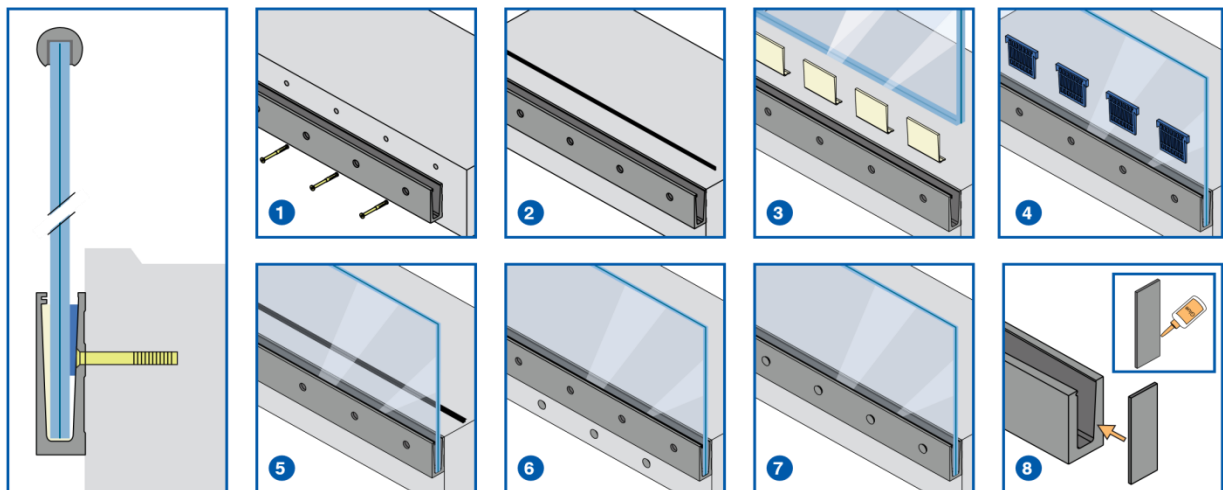

## Any Questions?

If you have any questions please ask us. We are always happy to help if we can.

Call: 01708 25 35 45

Email: [info@liveconfigurator.co.uk](mailto:info@liveconfigurator.co.uk)